

Existing Ground Floor Plan

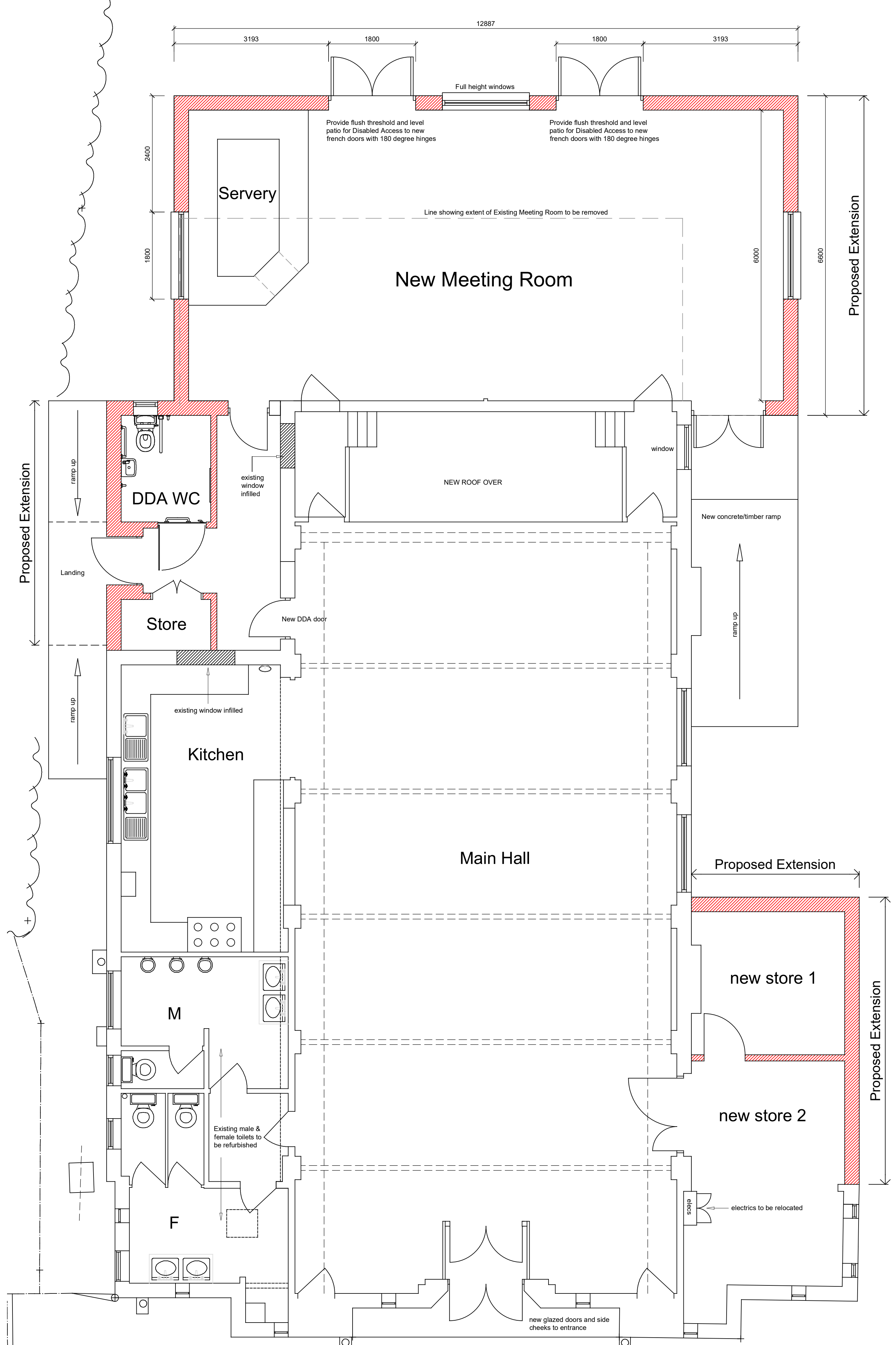

Proposed Ground Floor Plan

Rev	Notes	Date

BROWN MATTHEWS
ARCHITECTS
Chartered Architects · Historic Building Consultants
Oak Tree Design Studio, Wolverton Road, Snitterfield,
Stratford-upon-Avon, Warwickshire CV37 9NB Tel: 01789 730346

Snitterfield Village Hall
Bearley Road
Snitterfield
Warwickshire
CV37 0JH

Existing & Proposed Floor Plans

Scale: 1:50 @A1
Date: February 2018 Drawn: SN
Drawing number: 1719/04 Revision: -